

- Over **30** YEARS of Supplying Southern Africa -

# BirCRAFT

GEARED MOTORS - LINEAR ACTUATORS & CONTROLLERS



Website: [www.bircraft.co.za](http://www.bircraft.co.za) Fax: 086 694 5806 E-mail: [01@bircraft.co.za](mailto:01@bircraft.co.za) International Tel. +27 11 468 1881 Fax. +27 11 468 1698  
National Sales: **0861 BIRCRAFT** National Sales: **086 124 7272** **BEE Certified**

## SHORT FORM SELECTION Worm Gear Reducers



BASED ON 1400 PM INPUT SPEED

Model	Ratio	Output Rpm	Torque N	Max Input Power kW	Dimensions in mm	
030	7	200	15	0.37	A	80
	10	140	17	0.31	B	55
	15	93	18	0.23	C	40
	20	70	15	0.16	D	65
	30	46	19	0.15	E	97
	40	35	16	0.10	F	56
	50	28	15	0.08	G	40
	60	23	15	0.07	H	14
	80	18	12	0.05	I	63
040	7	200	37	0.93	A	100
	10	140	42	0.75	B	70
	15	93	42	0.54	C	50
	20	70	37	0.37	D	75
	30	46	43	0.34	E	122
	40	35	40	0.24	F	71
	50	28	38	0.20	G	50
	60	23	36	0.17	H	18
	80	18	26	0.11	I	78
050	7	200	68	1.7	A	120
	10	140	73	1.3	B	80
	15	93	76	0.93	C	60
	20	70	74	0.71	D	85
	30	46	80	0.60	E	144
	40	35	81	0.45	F	85
	50	28	72	0.34	G	60
	60	23	69	0.30	H	25
	80	18	58	0.21	I	92
100	14	52	0.16			

Model	Ratio	Output Rpm	Torque N	Max Input Power kW	Dimensions in mm	
063	7	200	115	2.9	A	144
	10	140	126	2.2	B	95
	15	93	131	1.60	C	72
	20	70	136	1.30	D	95
	30	46	135	1.00	E	174
	40	35	145	0.79	F	103
	50	28	125	0.58	G	72
	60	23	127	0.54	H	25
	80	18	110	0.37	I	112
	100	14	99	0.28		
075	7	200	205	5.05	A	172
	10	140	220	3.86	B	112
	15	93	230	2.79	C	86
	20	70	220	2.07	D	115
	30	46	255	1.87	E	205
	40	35	230	1.25	F	112
	50	28	220	1.02	G	86
	60	23	200	0.82	H	28
	80	18	185	0.61	I	120
	100	14	170	0.48		
090	7	200	320	7.8	A	206
	10	140	347	6.0	B	130
	15	93	371	4.4	C	103
	20	70	381	3.5	D	130
	30	46	414	2.9	E	238
	40	35	406	2.1	F	130
	50	28	368	1.6	G	103
	60	23	344	1.3	H	35
	80	18	297	0.9	I	140
	100	14	270	0.7		

LARGER GEAR UNITS AVAILABLE ON REQUEST

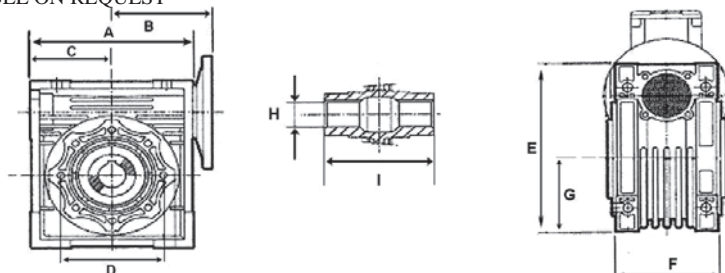

Optional extras : -  
Single or Double output shafts,  
Output Flange, Torque Arm.

Dimension Drawing:  
Guide lines Only - Subject to change.  
For more detailed data contact our  
Sales Department.

( SPECS FOR GUIDELINES ONLY )

**BAYSIDE**    **HUBNER**    **SPG**    **BODINE**    **BALDOR**    **REO-PRECILEC**    **LEESON**    **maxon**  
**PARVALUX**    **GEFEG NEKAR**    **GROSCHOPP**    **Dunker**    **RELIANCE**    **ENGEL**    **FIBER**    **Oriental**    **STM**

Member: Mr P. Birkett    Company Reg # 1989/001275/23    VAT Reg # 4500121290

HWP 05052010