

- Over 30 YEARS Supplying Africa -



BirCRAFT

GEARED MOTORS - LINEAR ACTUATORS - CONTROLS



Website: www.bircraft.co.za Fax: 086 694 5806 E-mail: 01@bircraft.co.za International Tel. +27 11 468 1881 Fax: 011 468 1698
 National Sales: **0861 BIRCRAFT** National Sales: **086 124 7272** Cell: **074 465 1744**
BEE Certified

Permanent Magnets

D.C. ELECTRIC MOTORS

Construction	Tubular, without fan
Size	Ø 80 mm
Power	250 W S2 (180 W S1)
Magnets	2
Bearings	Ball Bearings
Mounting Holes	4
Power Supply	Low voltage, 12 or 24 Vdc
Brushes	2 inside brushes made of graphite/copper composite
Brushes Size	L x W x H = 17.1 x 6.5 x 16.7 mm
Frame	Silver colour, satin-finish
Electric Cable	Length: 1000 mm

Approximate service life of the brushes: the rate at which the brushes wear down depends on the work conditions (start-stop frequency, overload conditions). Under conditions of nominal load, good power supply and operation without excessive electric arcs, the service life is approx. 3000 hrs.

Type	Duty S	Pn [W]	V [V]	I [A]	IC	FF	Mn [Nm]	n ₁ [min ⁻¹]	IP	Kg					
EC100.120	S1	180	12	21.5	F	1	0.57	3000	44	3.4					
	S2	250		30			0.8								
EC100.240	S1	180	24	10.8								0.57			
	S2	250		15			0.8								

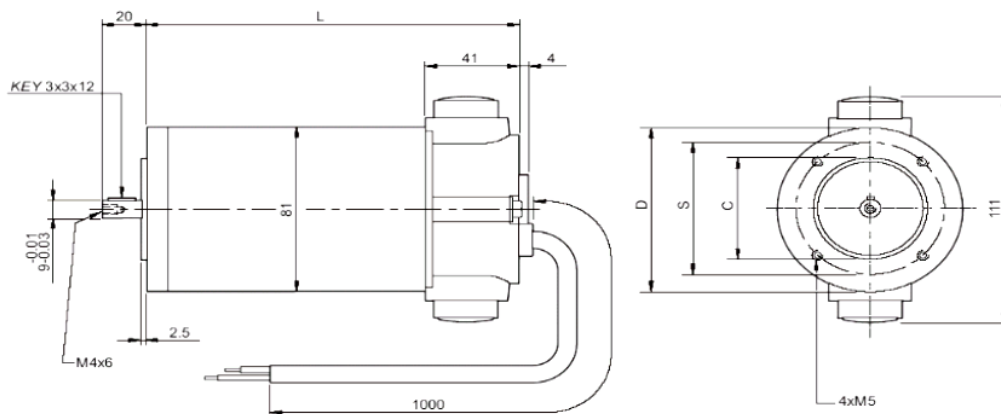

56 B14		63 B14	
L	185	L	187
D	80	D	90
S	65	S	75
C (-0.03/-0.01)	50	C (-0.03/-0.01)	60



BAUER



BODINE



REG-PRECILEC

LEESON

maxon

PARVALUX



HANNING

RELIANCE

ENGEL

HUBNER



Oriental STM

Member Mr. P Birkett

Company Reg # 1989/001275/23

VAT Reg # 4500121290