

- Over 30 YEARS Supplying Africa -



BirCraft

GEARED MOTORS - LINEAR ACTUATORS - CONTROLS

Website: www.bircraft.co.za Fax: 086 694 5806 E-mail: 01@bircraft.co.za International Tel. +27 11 468 1881 Fax: 011 468 1698
 National Sales: **0861 BIRCRAFT** National Sales: **086 124 7272** Cell: **074 465 1744**
BEE Certified

SHORT FORM SELECTION Compact Gear Motors

The SMALLEST INDUSTRIAL GEAR motors and BRAKE motors
Can replace PANASONIC & ORIENTAL Brands

Motor Types Available	Standard Motor 1 & 3 Phase	Reversible Motor	Variable Speed AC Motor	Variable Speed DC Motor	Brushless Motor NEW!	Mechanical Brake Motor	Electrical Brake Motor
-----------------------	----------------------------	------------------	-------------------------	-------------------------	-----------------------------	------------------------	------------------------



Speed Controllers

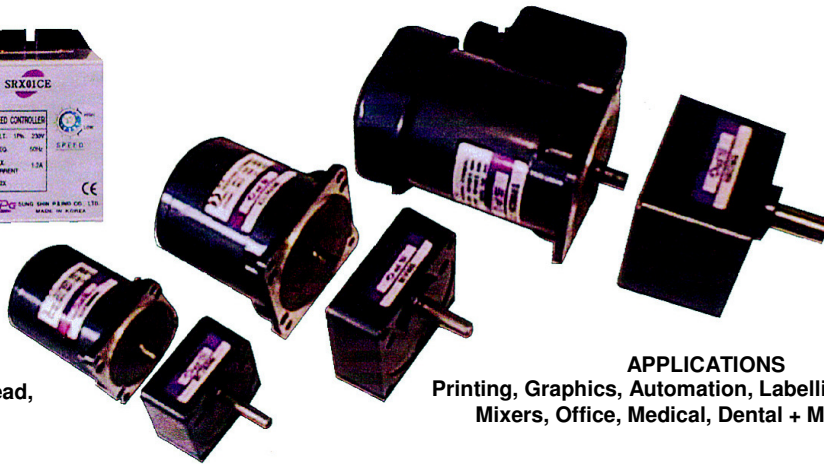

OPTIONS

Terminal Box, Heavy Duty Gear Head, "CE" Mark

APPLICATIONS

Printing, Graphics, Automation, Labelling, Conveyors, Mixers, Office, Medical, Dental + Many Others

RATIOS up to 20,000 / 1

Size Frame Ø mm	60	70	80	90	90	90	90	90	90	1300 Rpm
Wattage	6/15	15	25/40	40	60	9	120	150	180	
Torque Nm	0.05	0.13	0.22	0.33	0.46	0.69	0.75	0.95	1.4	
Standard Voltage Permanent Magnet	AC = 110 / 220v 1~ Phase, 220 / 380 vac 3~ Phase 50/60 Hz. 1300 rpm DC = (12v, 24v = 1500 rpm, 90v & 180v available on request at 3000 rpm)									

TORQUE CALCULATION = MOTOR (Nm) x GEAR RATIO x GEAR EFFICIENCY (NB. T2MAX)

Gear Ratio	3	5	7.5	10	15	20	30	40	50	75	100	150	200	Decimal Unit x 10
Output RPM at 1300 RPM	400	240	160	120	80	60	40	30	24	16	12	8	6	
6 ~40 WATT EFF	81%			73%			66%							
60~200 WATT EFF	81%			73%			66%			59%			59%	
See (T2mx)=	Limited by the Maximum Permissible Torque of Gearbox													

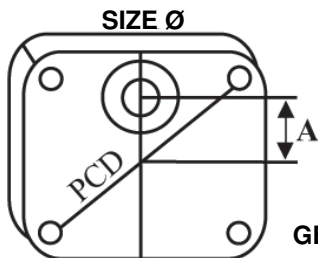

GEAR BOX

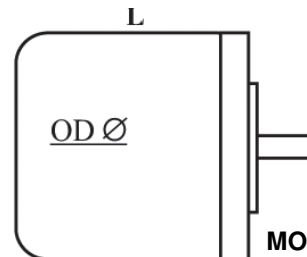

MOTOR

T2max	Size Ø	Length	PCD Ø	Spigot	Shaft Ø	A	Motor Length	OD Ø
3 Nm	60	30/40	70	24	8 x 29	10	75	60
5 Nm	70	42	82	31	10 x 29	15	80	70
8 Nm	80	32/42	94	34	10 x 29	15	85	80
9.8 Nm	A 90	42/60	103	36	12 x 29	18	105	90
19.6 Nm	B 90	60/65	104	36	15 x 30	18	122	90

(SPECS FOR GUIDELINES ONLY)



Member Mr. P Birkett

Company Reg # 1989/001275/23

VAT Reg # 4500121290